

- 1
- 2
- 3
- 4
- 5
- 6
- 7
- 8
- 9
- 10
- 11
- 12
- 13
- 14
- 15
- 16
- 17
- 18
- 19

**STANDARD EXECUTIONS**

Weldable AISI 316 turned stainless steel body.  
 Push-fit using AISI 316 stainless steel screws, cylindrical head with hexagonal socket.  
 Threaded pass-through hole ( $d1 = 20 \div 36$ ).  
 Threaded blind hole ( $d1 \geq 42$ ).

**FEATURES AND APPLICATIONS**

GN 706.2-A4 semi-split set collars can be used not only as end stops, but they can also be used for fixing other components, such as end limit switches.  
 No risk of damage to the surfaces of the shaft even when high clamping forces are necessary.  
 The clamping screw  $d3$  may be replaced by clamping kit GN 311 (see page -).

**TECHNICAL DATA**

Assembly on h11 tolerance shafts.

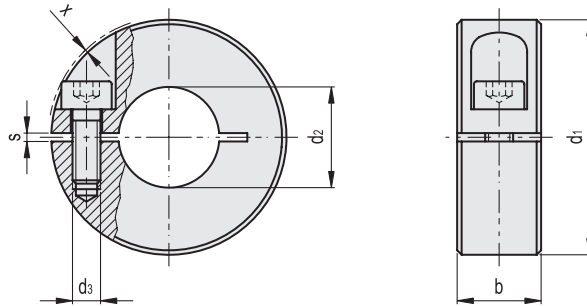

Code	Description	d1	d2 E8	d3	b±0.2	s	x*	⚖️
GN.45311	GN 706.2-20-B6-A4	20	B 6	M 3	9	1.6	1.2	19
GN.45312	GN 706.2-22-B8-A4	22	B 8	M 3	9	1.6	1	24
GN.45313	GN 706.2-26-B10-A4	26	B 10	M 4	11	1.6	1.6	37
GN.45314	GN 706.2-30-B12-A4	30	B 12	M 4	11	1.6	0.7	40
GN.45315	GN 706.2-32-B14-A4	32	B 14	M 4	11	1.6	0.7	52
GN.45316	GN 706.2-36-B15-A4	36	B 15	M 5	13	1.6	1.4	82
GN.45317	GN 706.2-36-B16-A4	36	B 16	M 5	13	1.6	1.4	78
GN.45318	GN 706.2-42-B18-A4	42	B 18	M 5	15	1.6	0.6	126
GN.45319	GN 706.2-42-B20-A4	42	B 20	M 5	15	1.6	0.6	119
GN.45320	GN 706.2-48-B22-A4	48	B 22	M 5	15	1.6	0	160
GN.45321	GN 706.2-48-B25-A4	48	B 25	M 5	15	1.6	0	147
GN.45322	GN 706.2-55-B28-A4	55	B 28	M 6	15	1.6	0.5	197
GN.45323	GN 706.2-55-B30-A4	55	B 30	M 6	15	1.6	0.5	185
GN.45324	GN 706.2-60-B32-A4	60	B 32	M 6	15	1.6	0.4	226
GN.45325	GN 706.2-60-B35-A4	60	B 35	M 6	15	1.6	0.4	207
GN.45326	GN 706.2-65-B40-A4	65	B 40	M 6	15	1.6	0.5	230

Standard machine parts

1 \* Max protrusion of the screw head.